

## Meeting & Banquet Room Information

### Meeting/Banquet Room Rental Rates ( June 2009 )

	Meeting rooms 139 and 140	Poplar	Maple	Birch	Oak	Cedar
<b>Partial Day</b>	\$135	\$135	\$135	\$135	\$400	\$400
<b>All Day</b>	\$150	\$150	\$150	\$150	\$500	\$500
<b>Saturday</b>	\$135	\$135	\$135	\$135	\$700	\$700

Prices for room rentals are based on meeting use only. We offer reductions based on meals ordered and guest room usage.

### Banquet Room Capacities

Name	Size	Sq. ft.	Classroom	Theatre	Boardroom	U-shape	Banquet	Banquet + Dance
<b>139</b>	15'-26'	390	16	30	20	18	30	-
<b>140</b>	32'x18'	576	20	40	20	20	40	-
<b>Poplar</b>	36'x23'	828	32	70	25	25	50	-
<b>Maple</b>	30'x22'	660	32	70	25	25	50	-
<b>Birch</b>	24'x22'	528	24	50	20	20	40	-
<b>Oak</b>	68'x40'	2720	80	200	50	40	200	135-150
<b>Cedar</b>	-	3500	80	200	50	40	200	175

Ceiling heights are 9 feet, with the exception of the Poplar Room which has a ceiling height of 7 1/2 feet. Meeting rooms 139 and 140 are adjacent to each other and located on main floor, both have windows. All other meeting and banquet rooms are located on the lower level.

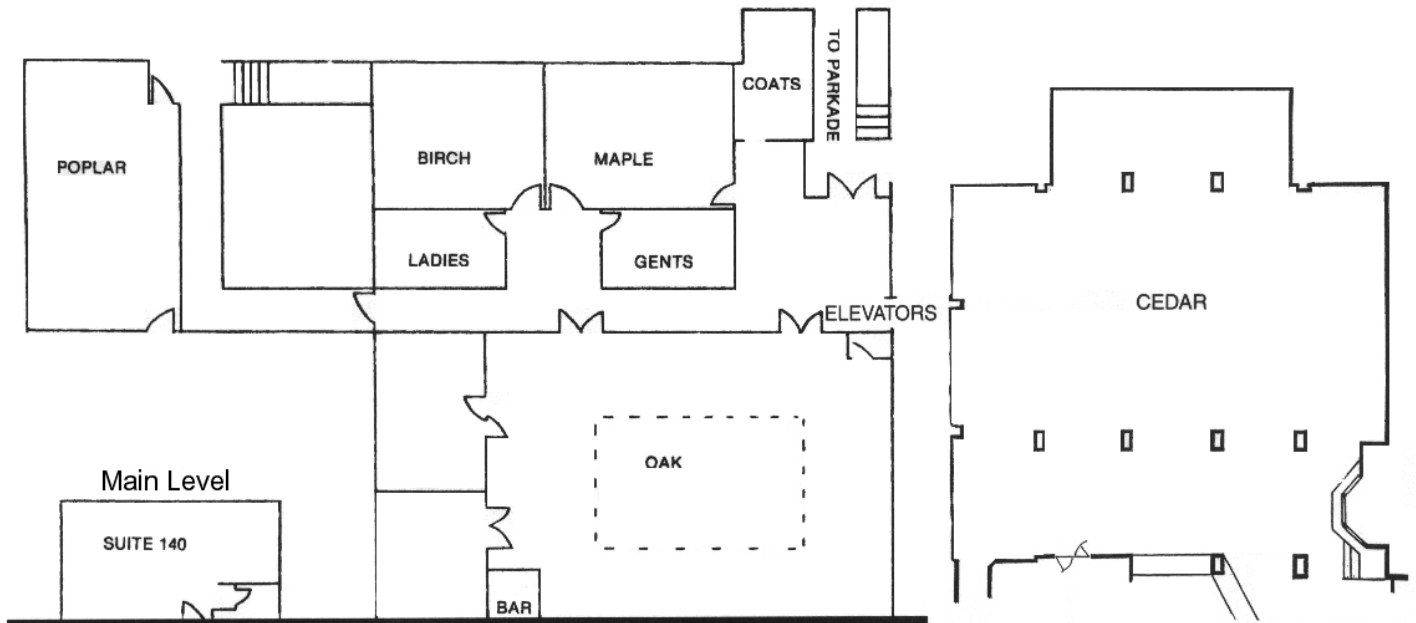

#### Please Note:

Screens, flip charts, easels, lecterns, and stage risers are available in all rooms. Audio-visual equipment must be arranged for in advance and is subject to applicable charges and taxes. A public address system is available in the Oak Room and the Cedar Room.